

**Sizes MDA 35.1 ... MDA 63.1, axial design**

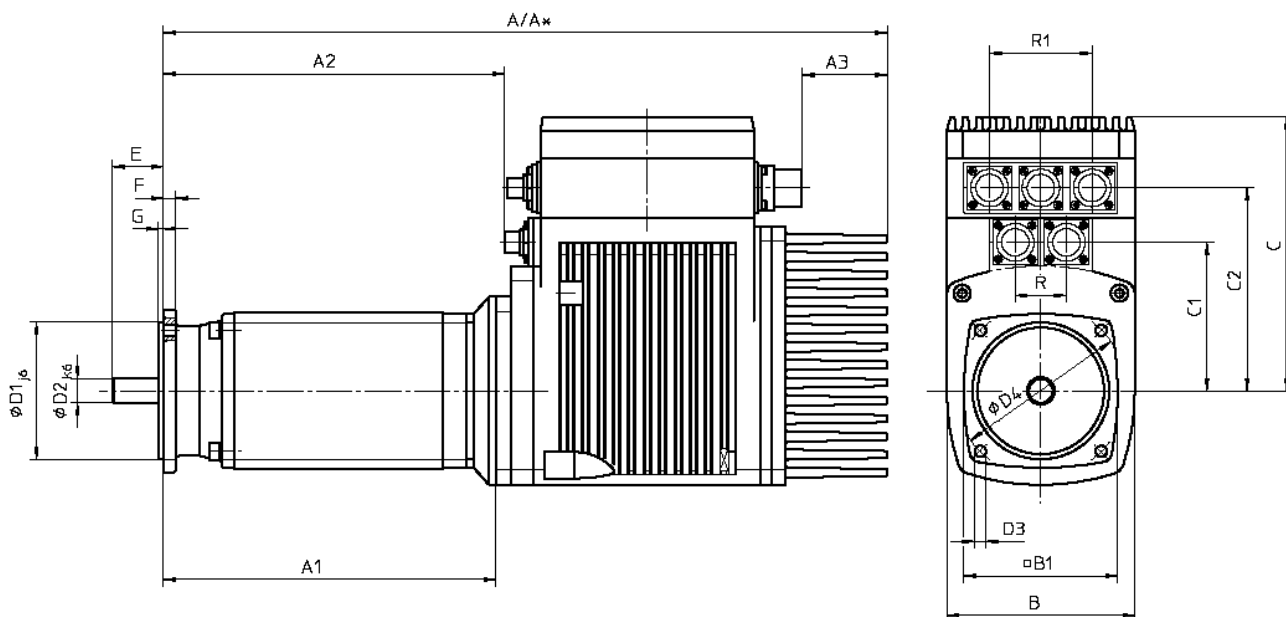

			resolver			Absolute encoder			
Dimensions in mm			MDA35.1	MDA56.1	MDA63.1	MDA35.1	MDA56.1	MDA63.1	
Dimensions servo drive	Length	without holding brake	A	365.0	423.5	437.5	372.5	423.5	446.5
		with holding brake	A*	383.0	448.5	437.5	390.5	448.5	446.5
	Length of motor	without holding brake	A1	181.5	194.5	208.5	181.5	194.5	208.5
		with holding brake	A1	199.5	219.5	208.	199.5	219.5	208.5
	Width		B	75	110	110	75	110	110
	Height		C	157.5	160.0	160.0	157.5	160.0	160.0
Flange dimensions motor	Motor flange, overall dimensions		B1	75	90	110	75	90	110
	Spigot ring, diameter		D1	60 <sub>j6</sub>	80 <sub>j6</sub>	95 <sub>j6</sub>	60 <sub>j6</sub>	80 <sub>j6</sub>	95 <sub>j6</sub>
	Shaft diameter		D2	11 <sub>k6</sub>	14 <sub>k6</sub>	16 <sub>k6</sub>	11 <sub>k6</sub>	14 <sub>k6</sub>	16 <sub>k6</sub>
	Bores for fastening		D3	5.5	6.6	9.0	5.5	6.6	9.0
	Pitch circle for fastening		D4	75	100	115	75	100	115
	Shaft length		E	23	30	40	23	30	40
	Motor flange, thickness		F	7	7	9	7	7	9
	Spigot ring, depth		G	2.5	3.0	3.0	2.5	3.0	3.0
	Groove dimension (option)		--	4P9	5P9	5P9	4P9	5P9	5P9
Distances for electrical connection	Motor shaft – connector level 1		C1	80.50	86.75	86.75	80.50	86.75	86.75
	Motor shaft – connector level 2		C2	116.0	118.5	118.5	116.0	118.5	118.5
	Clearance motor-side connector (standard version)		A2	180	199	213	187.5	199	222
	Clearance control-side connector (standard version)		A3	14	50	50	14	50	50
	Modular dimension of connector		R R1	30 —	30 60	30 60	30 —	30 60	30 60
Weight	Axial design	without holding brake [kg]		6.3	9.3	11.2	6.3	9.3	11.2
		with holding brake [kg]		6.6	9.9	11.7	6.6	9.9	11.7

## Sizes MDA 35.1 ... MDA 63.1, angular design

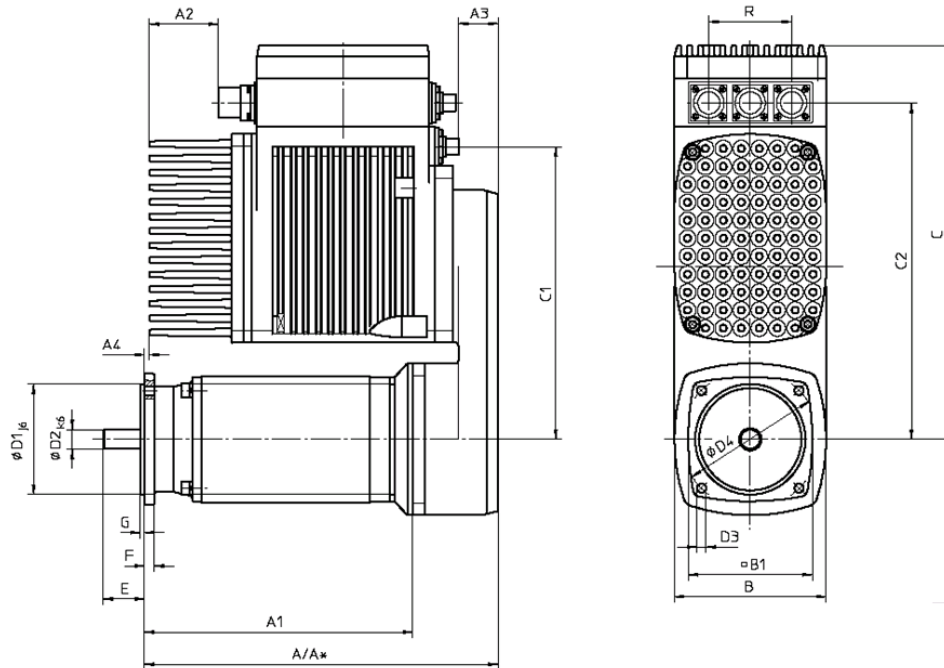

Identical dimensions for resolver version and absolute encoder					
	Dimensions in mm	Symbol	MDA35.1	MDA56.1	MDA63.1
Dimensions servo drive	Length without holding brake	A	229.0	245	257
	Length with holding brake	A*	247.0	270	257
	Length of motor without holding brake	A1	181.5	194.5	208.5
	Length of motor with holding brake		199.5	219.5	208.5
	Width	B	75	110	110
	Height	C	242.5	285.0	285.0
Flange dimensions motor	Motor flange, overall dimensions	B1	75	90	110
	Spigot ring, diameter	D1	60 <sub>16</sub>	80 <sub>16</sub>	95 <sub>16</sub>
	Shaft diameter	D2	11 <sub>k6</sub>	14 <sub>k6</sub>	16 <sub>k6</sub>
	Bores for fastening	D3	5.5	6.6	9.0
	Pitch circle for fastening	D4	75	100	115
	Shaft length	E	23	30	40
	Motor flange, thickness	F	7	7	9
	Spigot ring, depth	G	2,5	3,0	3,0
	Groove dimension (option)	--	4P9	5P9	5P9
Distances for electrical connection	Motor shaft – connector level 1	C1	165.5	211.75	211.75
	Motor shaft – connector level 2	C2	201.0	243.5	243.5
	Clearance motor-side connector (standard version)	A2	14	50	50
	Clearance control-side connector (standard version)	A3	10	9	9
	Clearance for heat dissipator – motor flange level	A4	30	6.5	6.5
	Modular dimension of connector	R	30	30	30
		R1	—	60	60
Weight	Angular design without holding brake [kg]		6.6	10.2	12.0
	Angular design with holding brake [kg]		6.9	10.7	12.5